



RAM Crew Cab Long Bed 3500 2014-2018

Thank you for choosing White Knuckle Rock Sliders

Please read instructions before beginning installation. Check hardware kit contents against content list below. Also, check the tools needed against the list below.

**Install time:** 2 hours

1 helper recommended

#### **Hardware Kit**

1-Driver Side Rock Slider

1-Passenger Side Rock Slider

3 – 1/2" X 2 X 9-7/16" Backing Plates

2 – 1/2" X 2 X 9-11/16" Backing Plates

2 – 1/2" X 2 X 9-5/8" Backing Plates

1 – 3/8" X 2 X 9-7/16" Backing Plate

2 – 1/4" X 2 X 9-7/16" Mounting Plate Shims (3<sup>rd</sup> Mount)

2 – 1/2" "J" Backing Plates and 2 Mounting Plate Shims (Front)

1 – 1/2" X 4-1/2" Grade 8 Bolt

15– 1/2" X 5" Grade 8 Bolts

18– 1/2" Nuts, Flat Washers, and Lock Washers

2 – 1/2" X 6" Grade 8 Bolts, Nuts and Extra Thick Washers (9/16" X 6", 5/8" X 6", 3/4" X 6" If Radius Arm Drop Brackets are Installed)

#### **Tools Needed**

Floor Jack

2 Axle Stands

3/4" Wrench and/or

Ratchet and 3/4"

Socket

#### **INSTALLATION INSTRUCTIONS**

1. Chock your wheels to prevent your truck from rolling. Begin the install on the passenger side first. Place the axle stands directly under the rocker panel. Place the rock slider on the axle stands **Figure 1**. Place another axle stand or floor jack under one of the mounting plates or legs to keep the slider from swinging out and to provide more stability.
2. **Driver side only** – A couple of the plastic snap-in fasteners that attach the wire loom to the top of the frame rail will need to be removed or cut to provide slack in the loom which will allow the backing plates in a couple of the mounting points to be installed **Figure 2**. Be sure the wire loom is protected from wear if against the backing plates with rubber and/or electrical tape.

3. Position the rock slider mounting plates flush against the frame so that they are in a position high enough to push the bolts from the outside toward the inside of the vehicle frame and through the backing plate. **NOTE:** Slide the backing plates up from the bottom against the inside of the frame to insure brake lines, wiring, etc. will not be pinched by the backing plate **Figure 3**. Next push the bolts through the holes in the mounting plates (begin with the Front mount then work your way back) **NOTE:** The 1/4" X 2" X 9-7/16" shims are to be placed between the 3<sup>rd</sup> mounting plate and the frame **Figure 4**. **NOTE:** The 1/2" X 6" bolt with Extra Thick Washers is used on the front slider mounting lower hole and also goes through the factory 1" hole in the frame at the same location **Figure 5**. Place the flat washers, lock washers and nuts on the bolts but do not tighten at this point. **NOTE:** The rear mount on the driver side should be installed backwards (from inside to outside of frame).
4. The front mounting plates requires a shim (included) to be placed at the top of the mounting position between the mounting plates and the frame **Figure 5**. A strong magnet, tape, or a friend's helping hand can be used to hold the shim in place while tightening the mounting bolts.
5. Once all of the washers and nuts have been started on the bolts, center the slider relative to the rocker panel. Keep a consistent gap (around 1") between the slider and the bottom of the rocker panel. The gap can be adjusted by simply lifting one end (a bottle jack or floor jack used under the mount to be adjusted works best). Tighten all of the nuts rotating from top to bottom to ensure the backing plate stays straight. Finally, recheck each for tightness.
6. **NOTE:** If you notice a creaking sound while driving, it is most likely the top of the 2<sup>nd</sup> position backing plate making contact with the bottom of the cab. Loosen the bolts and drop the backing plate until it does not make contact. Make sure the top bolt is level to the top of the frame or slightly dipping downward toward the backing plate.

**Figure 1**



**Figure 2**

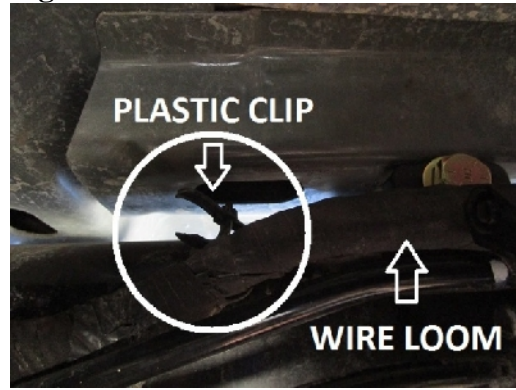

**Figure 3**



**Figure 4**



**Figure 5**

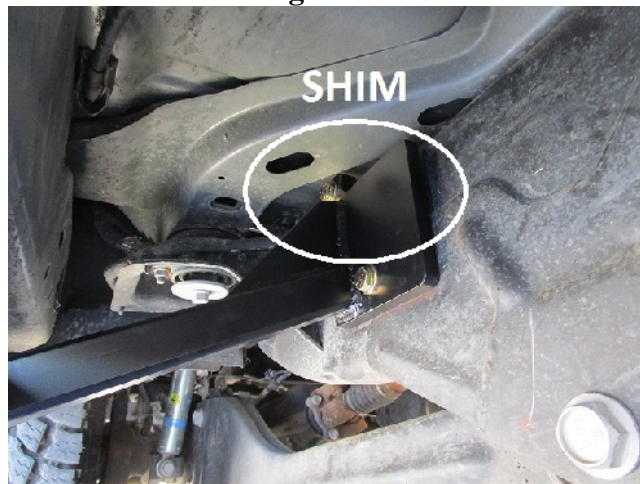

## **SAFETY FIRST**

**Observe proper safety procedures during installation. Improperly used tools and unsafe procedures can cause injury or death. Refer to manufacturers manuals for use and warnings of tools to be used.**

**Modifications to your vehicle can cause dangerous conditions. The buyers and users of this product assume all risks associated with the installation and use of this product. All installations should be made by a qualified mechanic.**

## **DISCLAIMER**

**White Knuckle Off Road Products, LLC stands behind all of our quality off-road fabricated products. WKORP will not be held responsible nor will we accept liability for failure of parts as a result of extreme off-road use. Minor modifications may be required to allow the installation of our products.**

**Modifications to your vehicle using products manufactured by WKORP may create dangerous conditions. Modifications to your vehicle are done at your own risk. WKORP will not accept responsibility or liability from damage or personal injury caused by installing or using installed products manufactured by WKORP whether intended or unintended. The buyer accepts all responsibility and risks associated with any modifications using WKORP manufactured products. All products manufactured by White Knuckle Off Road Products, LLC are for off-road use only.**

**The powder coated finish provided by WKORP will carry no warranty or guarantee. The powder coated finish is provided as a service. Any damage to the finish during shipping must be reported immediately. Any damage, wear, or anomalies incurred to the finish after receiving parts from WKORP are the responsibility of the buyer or user.**

**[www.white-knuckleoffroad.com](http://www.white-knuckleoffroad.com)**