



RAM Crew Cab Long Bed 3500 2014-2021

Thank you for choosing White Knuckle Rock Sliders

Please read instructions before beginning installation. Check hardware kit contents against content list below.

Also, check the tools needed against the list below.

Install time: 2-3 hours

1 helper recommended

Hardware Kit

- 1-Driver Side Rock Slider
- 1-Passenger Side Rock Slider
- 3 – 1/2" X 2 X 9-7/16" Backing Plates
- 2 – 1/2" X 2 X 9-11/16" Backing Plates
- 2 – 1/2" X 2 X 9-5/8" Backing Plates
- 1 – 3/8" X 2 X 9-7/16" Backing Plate
- 2 – 1/4" X 2 X 9-7/16" Mounting Plate Shims (3rd Mount)
- 1 – 1/8" X 2 X 9-11/16" Mounting Plate Shim (2nd Mount 2019-Newer)
- 2 – 1/2" "J" Backing Plates and 2 Mounting Plate Shims (Front)
- 1 – 1/2" X 4-1/2" Grade 8 Bolt (Driver Side Rear Top)
- 19– 1/2" X 5" Grade 8 Bolts, Nuts, Flat Washers, and Lock Washers

Tools Needed

- Floor Jack
- 2 Axle Stands
- 3/4" Wrench and/or Ratchet and 3/4" Socket

INSTALLATION INSTRUCTIONS

1. Chock your wheels to prevent your truck from rolling.
2. Remove the plastic trim at the bottom of the bed at the front **Figure 1**.
3. Place the axle stands directly under the rocker panel. Place the rock slider on the axle stands **Figure 2**. Place another axle stand or floor jack under one of the mounting plates or legs to keep the slider from swinging out and to provide more stability.
4. **Driver side only** – A couple of the plastic snap-in fasteners that attach the wire loom to the top of the frame rail will need to be removed or cut to provide slack in the loom which will allow the backing plates in a couple of the mounting points to be installed **Figure 3**. Be sure the wire loom is protected from wear if against the backing plates with rubber and/or electrical tape.
5. **Passenger side only 2019-Newer** – To access the front backing plate to install the washers and nut at the top of the plate, remove the 3 screws that fasten the exhaust hanger to the frame and swing it out of the way **Figure 4**. To access the 2nd backing plate top nut and washers, reach your arm between the exhaust and the transfer case.
6. Position the rock slider mounting plates flush against the frame so that they are in a position high enough to push the bolts from the outside toward the inside of the vehicle frame and through the backing plate. **NOTE:** Slide the backing plates up from the bottom against the inside of the frame to ensure brake lines, wiring, etc. will not be pinched by the backing plate **Figure 5**. Next push the bolts through the holes in the mounting plates (begin with the Front mount then work your way back) **NOTE:** The 1/2" X 5" bolt with Extra Thick Washers is used on the front slider mounting lower hole and also goes through the factory 1" hole in the frame at the same location **Figure 6**. **NOTE:** The 1/4" X 2" X 9-7/16" shims are to be placed between the 3rd mounting plate and the frame **Figure 7**. **NOTE:** The 1/2" X 4-1/2" bolt goes to the rear mount on the driver

side top and should be installed reversed. **NOTE:** If you have limited space between the fuel tank and the 4th and rear mounts, reverse the bottom bolts to go from the inside of the frame to the outside

7. The front mounting plates require a 3/16" "L" shim (included) to be placed at the top of the mounting position between the mounting plates and the frame **Figure 8**. A strong magnet or a friend's helping hand can be used to hold the shim in place while tightening the mounting bolts. The shim may already be welded in place.
8. Once all of the washers and nuts have been started on the bolts, center the slider relative to the rocker panel. Keep a consistent gap (around 1/2" to 1") between the slider and the bottom of the rocker panel. The gap can be adjusted by simply lifting one end (a bottle jack or floor jack used under the mount to be adjusted works best). Tighten all of the nuts rotating from top to bottom to ensure the backing plate stays straight. Finally, recheck each for tightness. Torque value is about 60 ft lbs for the 1/2" bolts.
9. **NOTE:** If you notice a creaking sound while driving, it is most likely the top of the 2nd position backing plate making contact with the bottom of the cab. Loosen the bolts and drop the backing plate until it does not make contact. Place a slotted screwdriver between the top of the plate and the cab to create a gap, retighten the bolts, then remove the screwdriver.
10. **Radius Arm Drop Brackets installed.** Remove the upper radius arm drop bracket bolt that goes thru the center of the frame. This frame hole will be used for the bottom slot of the slider front mounting plate. Retighten this bolt to the lift manufacturer's torque value. Supplied are new bolts, washers, and nuts. Also supplied are thick shims that go between the front mounting plate and the frame as well as the front backing plate and frame to allow for the added thickness to the frame by the drop brackets **Figures 9 & 10**.

Figure 1



Figure 2



Figure 3

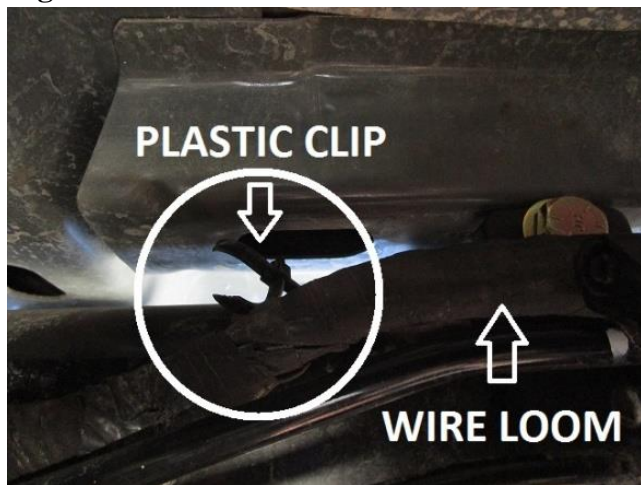

Figure 4



Figure 5



Figure 6



Figure 7



Figure 8



Figure 9



Figure 10



SAFETY FIRST

Observe proper safety procedures during installation. Improperly used tools and unsafe procedures can cause injury or death. Refer to manufacturers manuals for use and warnings of tools to be used. Modifications to your vehicle can cause dangerous conditions. The buyers and users of this product assume all risks associated with the installation and use of this product. All installations should be made by a qualified mechanic.

DISCLAIMER

White Knuckle Off Road Products, LLC stands behind all of our quality off-road fabricated products. WKORP will not be held responsible nor will we accept liability for failure of parts as a result of extreme off-road use. Minor modifications may be required to allow the installation of our products. Modifications to your vehicle using products manufactured by WKORP may create dangerous conditions. Modifications to your vehicle are done at your own risk. WKORP will not accept responsibility or liability from damage or personal injury caused by installing or using installed products manufactured by WKORP whether intended or unintended. The buyer accepts all responsibility and risks associated with any modifications using WKORP manufactured products. All products manufactured by White Knuckle Off Road Products, LLC are for off-road use only. The powder coated finish provided by WKORP will carry no warranty or guarantee. The powder coated finish is provided as a service. Any damage to the finish during shipping must be reported immediately. Any damage, wear, or anomalies incurred to the finish after receiving parts from WKORP are the responsibility of the buyer or user.

www.white-knuckleoffroad.com